

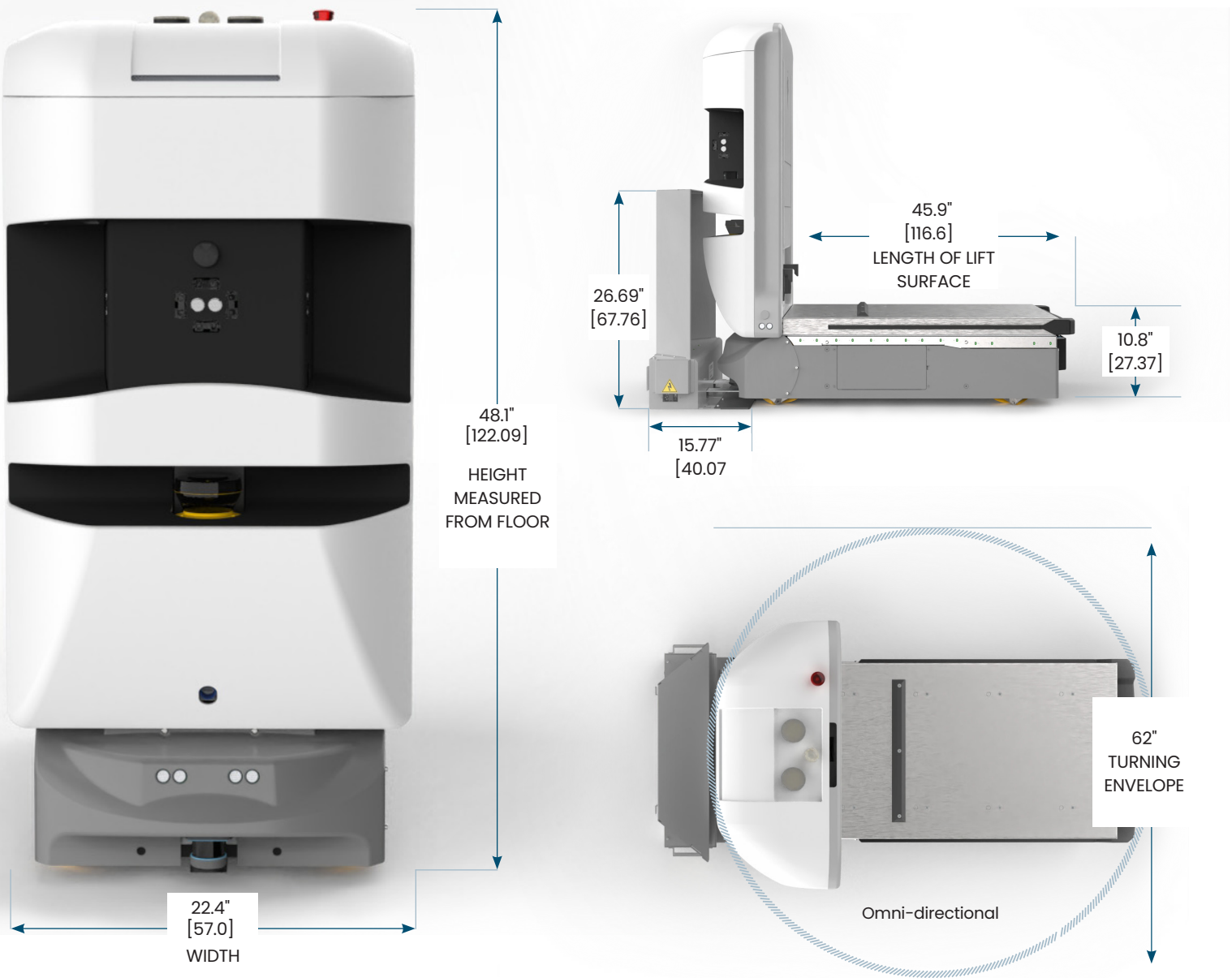

T3XL

The T3XL is a smart autonomous mobile robot that automates the transport of materials and supplies in commercial environments.

DIMENSIONS AND TURNING RADIUS



The **T3XL** is an enhanced payload capacity smart autonomous mobile robot that automates the transport of materials and supplies in commercial environments. The total capacity for the T3XL is 1,000 lbs (454 kg), and it is able to carry carts up to 56" (142 cm) long. Aethon differentiates itself from traditional AGV systems by requiring no infrastructure for navigation.

 **24/7 DELIVERY**
Improved productivity

 **NIMBLE, OMNIDIRECTIONAL**
Robust locomotion

 **24/7 SUPPORT**
Help desk support

 **SAFE**
Obstacle detection, avoidance

 **AUTOMATIC**
Pickup and dropoff

 **AUTO-DOCKING**
With auto charging

SPECIFICATIONS	T3XL	STANDARDS COMPLIANCE
Max Cart Size	56"L x 32"W (142.2 x 81.3 cm)	<ul style="list-style-type: none"> • EN 12100:2010, EN 60204-1:2006+A1:2009, IEC 60034-1:2004-04 • EN 61000-6-4:2007; EN 61000-6-2:2005; EN 60601-1-2:2007, EN 55022 • EN 301 489-1, EN 301 489-17 • FCC CFR 47, Part 15; ICES-001; Australian RCM Compliance • ETSI EN 300 220-1 V2.4.1 & ETSI EN 300 220-2 V2.4.1 • EN 300 328 1.7.1, EN 301 893 1.6.1
Weight Capacity	1000 lbs (454 kg)	
Max Travel Speed	30" per second (76 cm)	
Turning Envelope	62" (157 cm)	
Drive System	4WD - Omni-directional	
Battery Type	LiFePO4	
Effective Run-Time	9.0 hours	
Depleted Charge Time	3.2 hours	
Charger Power	8 amp wall receptacle	
Communications	WiFi	
Support	Encrypted to Command Center	
Elevator Integration	Hardware or Software	
Environmental	Interior Use	
Max Threshold Height	0.50" (12.70 mm)	
Max Gap Distance	1.25" (31.75mm)	

 This device complies with part 15 of the FCC Rules. Operation is subject to the following two conditions: (1)

 This device may not cause harmful interference, and (2) this device must accept any interference received, including interference that may cause undesired operation.

Aethon Inc.
200 Business Center Dr.
Pittsburgh, PA 15205

412-322-2975
www.aethon.com
inquiries@aethon.com

 **ST Engineering**

 **AETHON**